

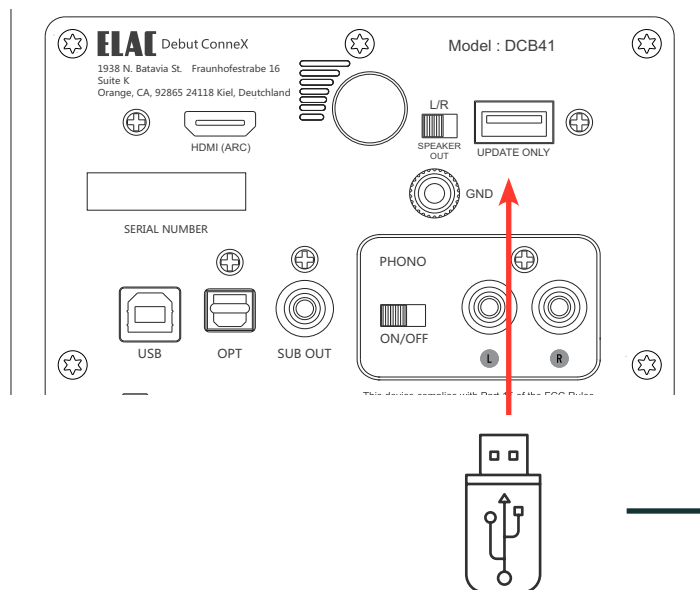

# FIRMWARE UPDATE

CONNEX SERIES

## 1 FIRMWARE UPDATE



USB FLASH DRIVE:

You will need a USB drive smaller than 8 GB, and it needs to be formatted to FAT32 file system.

1. Unplug power cable and leave off for 2 minutes to allow all internal voltages to deplete.
2. Uncompress the zip files and load onto the **ROOT DIRECTORY** of your Flash Drive.
3. Note: There should be a total of 4 files that must be copied directly to the Flash Drive must be the **ROOT DIRECTORY**.
4. Insert the USB drive as indicated by the red arrow and plug in the power cord.
5. Programming will start automatically. LED will flash white, indicating update is in progress.
6. **\*\*Important\*\*** During the upgrade, do not remove the USB drive. This can cause issues and brick the speakers. Please be careful!
7. If upgrade is successful, the LED will flash white/green.
8. You can now unplug the power cable. Wait 2 minutes before removing the USB, and then plug in the power cable.
9. **\*\*Important\*\*** Wait 2 minutes prior to applying power or you may lose the update.