

PR81-B 9-Outlet Smart Component Surge Protector Setup Guide

PRODUCT FEATURES

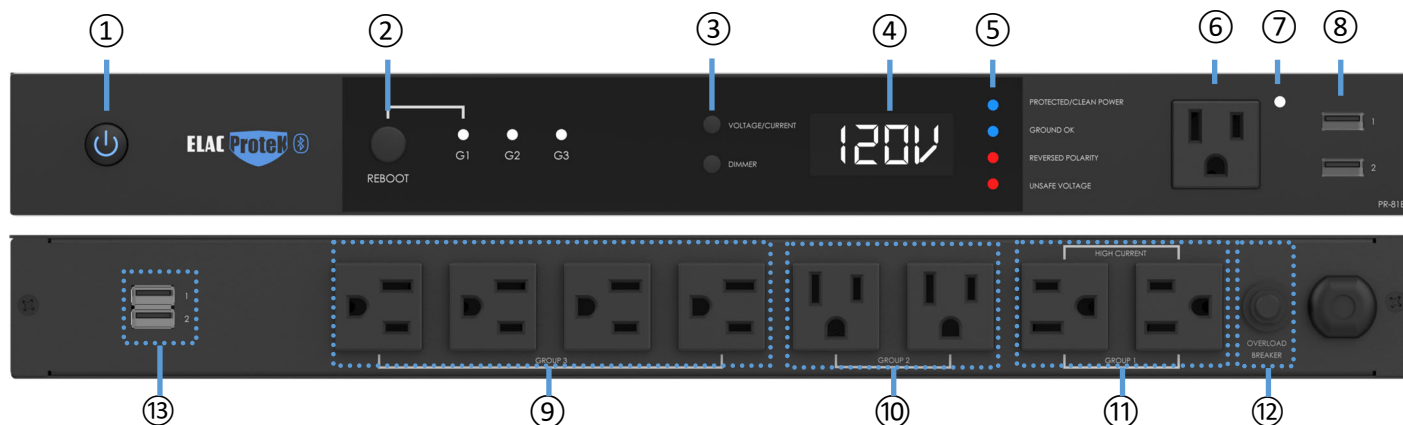

① Power Button—Press this button (.5 sec to 1 sec) to power on and off the rear AC outlets. Press and hold for 10 seconds to factory reset the unit.

② Reboot Button—Pressing and holding the REBOOT button for 1.5 seconds will power cycle all outlets in Group 1.

③ Voltage / Current Button and Dimmer Button—The Voltage / Dimmer button switches the display to show Voltage or Current. The dimmer button adjusts the brightness of the display and other LEDs to 10%, 35%, 70% and 100%.

④ Display —Displays the voltage coming into the surge protector or the current usage of all connected devices.

⑤ LED Indicators— Indicates the status of the surge protector

- **Protected / Clean Power**—LED On: Outlets are Protected. LED Off: Surge Protection is not working and your connected devices are not protected.
- **Ground OK**—LED On: The wall outlet is properly grounded. LED Off: The wall outlet is NOT properly grounded and a licensed electrician should be called to resolve the problem.
- **Reversed Polarity**—LED Off: The wall outlet polarity is correct. LED On: Reverse polarity detected. Please contact a licensed electrician to resolve the issue.

- **Unsafe Voltage**—LED Off: Normal voltage detected. LED On: Unsafe voltage detected and the surge protector will disconnect power to your connected devices. Please consult a licensed electrician.

⑥ Front AC Outlet—This front AC outlet is always on unless unsafe voltage is detected.

⑦ Front Outlet Indicator—Front AC outlet power indicator.

⑧ Front Dual USB Charging Ports: 5V 2.4 Amp Total USB-A ports for charging compatible devices.

⑨ Group 3 AC Outlets— These 4 outlets provide 70db of EMI/RFI filtration and are perfect for source and lower current devices.

⑩ Group 2 AC Outlets— These 2 outlets provide 70db of EMI/RFI filtration and are perfect for source and lower current devices.

⑪ Group 1 AC Outlets—These 2 outlets are designed for high current devices such as audio amplifiers.

⑫ Overload Breaker—This breaker will trip when the surge protector is overloaded. After resetting, please ensure the Protected/Clean Power LED is On, if not, your surge protector needs to be replaced.

⑬ Rear USB Charging Ports: 5V 2.4 Amp Total USB-A ports for charging compatible devices.

USING YOUR SURGE PROTECTOR

1. Ensure the power is off on the devices you will be connecting to the AC outlets on the surge protector.
2. Plug the surge protector into a properly grounded AC wall outlet and turn on the surge protector.
3. Check that the PROTECTED and GROUNDED blue LEDs are illuminated. If the PROTECTED LED is not illuminated, the surge protector is not operating properly and will not protect your connected devices. If the GROUNDED LED is not illuminated the outlet the surge protector is connected to is not properly grounded and should not be used. Please have a licensed electrician diagnose and troubleshoot the affected wall outlet prior to use.
4. Plug your equipment into the outlets on the surge protector and power on your devices as usual.
5. USB devices can be charged/powered by simply connecting the USB power cord to the USB ports on the surge protector. The USB ports deliver 5V and up to 2.4amps of power.

CONNECTING AND CONTROLLING THE PR81-B WITH THE ELAC PROTEK APP

1. Download and open the ELAC Protek App from either the iOS App Store or the Google Play Store.
2. In the App create an ELAC Protek account.
3. On the Home Screen Click on “Add Device”.
4. On the next screen choose Auto Scan (Top Right).
5. Press and Hold the Power Button on the PR81-B for 10 seconds until the unit reboots.
6. The Device will appear in the Available Devices Found screen.
7. Click Next or the + symbol and when prompted click “done”.
8. The PR81-B should now be connected to your phone/tablet and be controllable. This process can take up to one minute.
9. In the app you can now rename outlet groups, set timers, and schedules. Visit ELAC.COM for videos on how to get the most out of your PR81-B.

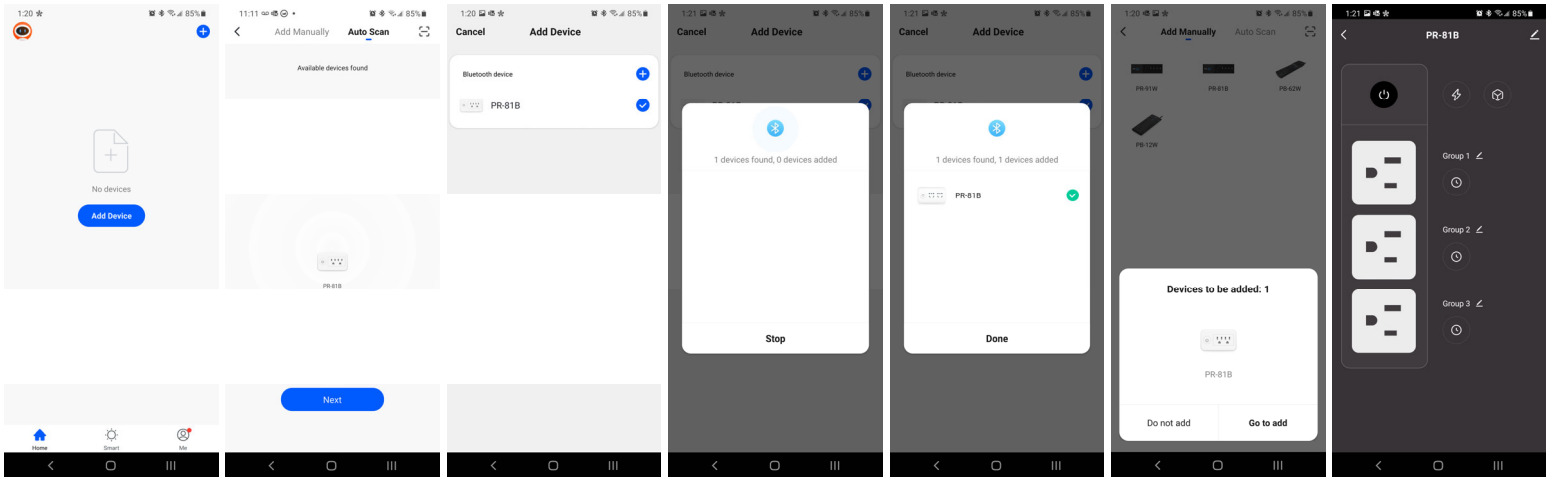

ELAC Protek App Screen Shots

SAFETY INFORMATION

- RISK OF ELECTRIC SHOCK – Use only in dry locations and only indoors.
- DO NOT plug into another relocatable power tap.
- DO NOT “daisy chain” surge protectors.
- DO NOT plug into 220V outlet or power source
- DO NOT use with any aquarium equipment.
- DO NOT connect to an ungrounded outlet.
- DO NOT install this device if there is not at least 30 feet (10 meters), or more of wire between the electrical outlet and electrical service panel.
- This device features internal protection that will disconnect the surge protective component at the end of its useful life (PROTECTED LED WILL TURN OFF) , but will maintain power to outlet – WHICH WILL BE UNPROTECTED. If you don't want your equipment at risk, follow the manufacturer's instructions for replacing the device.
- DO NOT use in any circumstance that would affect the operation or reliability of life support equipment, any medical applications, or patient care.

TECHNICAL SPECIFICATIONS

Number of AC Outlets	9
Number of USB Ports	4—5V total 2.4A (2 Rear, 2 Front)
AC Outlets	All 9 filtered with surge protection
Protection Modes	Surge / Over Under Protection
Over/Under Voltage Protection	Over 135Vac / Under 95Vac
Thermal Fuse	Yes
Maximum Current	15 Amps
Line Voltage	120V @ 60Hz
Certification	UL 1449, UL 1363, FCC, ICES
Max Energy Dissipation	3240 Joules
Max Spike Voltage / Current	6,000V / 165,000A
Response Time	1 Nanosecond
Filtration	EMI / RFI G1: 40dB G2: 70dB
Bluetooth	BLE (Bluetooth Low Energy) 2.4GHZ
App Control	ELAC Protek App (Free Download)
App Capabilities	Group Controlled Outlets, Scheduler, Timer

CAUTIONS!

This surge protector is designed to protect your electronic equipment from AC power surges up to its rated specifications only. If an electrical surge above the rated specifications of this surge protector enter this device, connected devices may not be protected. Please understand that electrical surges can enter electronics devices through any interconnected conductive connections. These interconnections can include coax lines, phone lines, ethernet lines, AV connections and any other conductive material.

FEDERAL COMMUNICATIONS COMMISSION INTERFERENCE STATEMENT

This equipment has been tested and found to comply with the limits for a Class B digital device, pursuant to Part 15 of the FCC Rules. These limits are designed to provide reasonable protection against harmful interference in a residential installation. This equipment generates, uses and can radiate radio frequency energy and, if not installed and used in accordance with the instructions, may cause harmful interference to radio communications. However, there is no guarantee that interference will not occur in a particular installation. If this equipment does cause harmful interference to radio or television reception, which can be determined by turning the equipment off and on, the user is encouraged to try to correct the interference by one or more of the following measures:

- Reorient or relocate the receiving antenna.
- Increase the separation between the equipment and receiver.
- Connect the equipment into an outlet on a circuit different from that to which the receiver is connected.
- Consult the dealer or an experienced radio/TV technician for help.

CAUTION:

To assure continued FCC compliance:

Any changes or modifications not expressly approved by the grantee of this device could void the user's authority to operate the equipment.

FCC ID & IC Statements

To assure continued FCC compliance:

1. Any changes or modifications not expressly approved by the grantee of this device could void the user's authority to operate the equipment.
2. This equipment complies with FCC radiation exposure limits set forth for an uncontrolled environment. This equipment should be installed and operated with minimum distance 20cm between the radiator & your body.

This device complies with Industry Canada license-exempt RSS standard(s). Operation is subject to the following two conditions: (1) this device may not cause interference, and (2) this device must accept any interference, including interference that may cause undesired operation of the device.

WARRANTY

ELAC Americas Inc. warrants to the original purchaser that this product be free from defects and or workmanship for 3-Years from the original date of purchase. During this time period, repair or replacement will be free of charge to the original owner (See below limitations). Shipping to and return from the repair center will be the responsibility of the original purchaser.

Limitations

- Warranty begins on the date of original purchase from an authorized ELAC Americas Inc. dealer. Warranty on products purchased from an unauthorized reseller will not be honored.
- Product is warranted only if used in home applications within the rated specifications of this product. Commercial use of this product is not warranted.
- Product that has been modified or altered in anyway will not be warranted.
- Product that has been abused or subjected to faulty equipment will not be warranted.
- Products with defaced or removed serial numbers will not be warranted.

If service is required

In the event that service is required, please contact ELAC America at 714-252-8843 or at customerservice@elac.us to request a return authorization and to arrange for service or replacement. Whether the product will be serviced or replaced is at ELAC's discretion. You will be responsible to provide proof of purchase (Copy or original sales receipt). Shipping to and from our repair center will be the responsibility of the original purchaser.

